













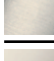

36 050 970



- ohne Rosette

Eigensicher gegen Rückfließen.

Passt zu: IMO, LULU, MADISON, MEM,  
TARA, CL.1, LISSÉ, VAIA, META, CYO

	Champagne (22kt Gold)	36 050 970-47
	Chrom	36 050 970-00
	Platin gebürstet	36 050 970-06
	Platin	36 050 970-08
	Dark Brass matt	36 050 970-16
	Dark Chrome	36 050 970-19
	Light Gold	36 050 970-26
	Light Gold gebürstet	36 050 970-27
	Messing gebürstet (23kt Gold)	36 050 970-28
	Schwarz matt	36 050 970-33
	Bronze gebürstet	36 050 970-42
	Champagne gebürstet (22kt Gold)	36 050 970-46
	Chrom gebürstet	36 050 970-93
	Dark Platin gebürstet	36 050 970-99

36 050 970

mm [inches]

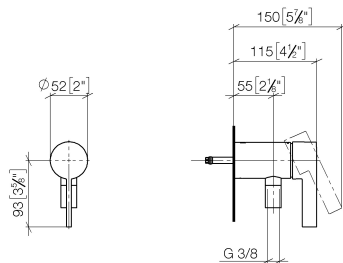

### Durchflussdiagramm

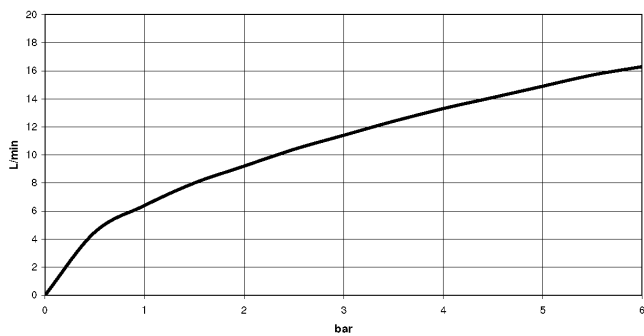

36 050 970

Ersatzteile für die  
anderen  
Oberflächenvarianten  
finden Sie hier:  
Chrom

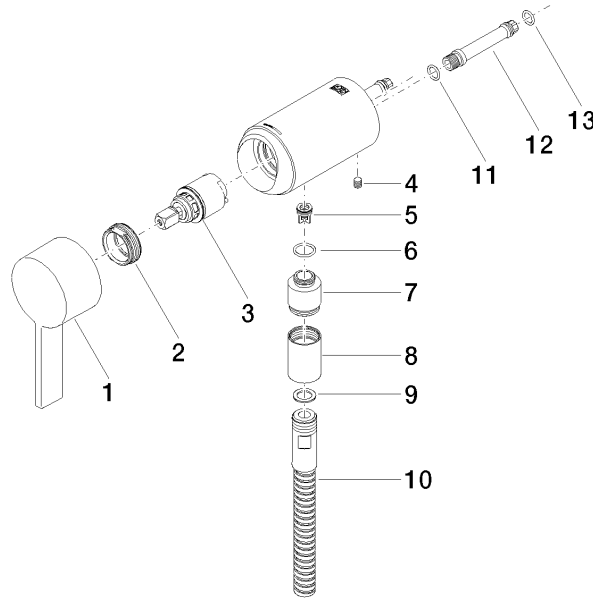

## Ersatzteilstückliste

Nr.	Artikelnummer	Benennung	Verbaumenge	Lieferzeit
1	90 20 97 064 00-47	Griff	1	30
2	09 24 04 266 90	Mutter	1	2
3	90 15 05 044 04 90	Kartusche	1	10
4	09 31 11 004 90	Stift	1	60
5	09 23 01 131 90	Rueckflussverhinderer	1	2
6	09 14 10 213 90	Dichtung	1	2
7	09 24 03 281-47	Nippel	1	60
8	90 21 02 069 00-47	Haube	1	30
9	90 14 20 026 00 90	Dichtung	1	2
10	28 322 970-47	Metall-Brauseschlauch 1/2" x 3/8" x 1750 mm - Champagne (22kt Gold)	1	30
11	90 14 10 060 00 90	Dichtung	1	2
12	09 18 40 230 90	Anschluss	1	2
13	09 14 10 061 90	Dichtung	1	2